

1  
9  
7  
8



Anuben Thakkar moved to Goraj and wanted to initiate day care and kindergarten.



The project initiated began at **Muni Seva Ashram**.



Orphanage named **Parivar Mandir** was started.



**Dr. Vikram Patel** joined in as a young doctor and conducted health checks on every Sunday at Anuben's hut.



Retirement homes for senior citizens named **Vanaprasth Mandir** was initiated.

**Kailash Cancer Hospital** and research centre was also established.



**Cyclotron** for Nuclear treatments of Cancer patients was established.



Guest house or **Atithi Mandir** was started



## LOCATION:



## LANDSCAPE INTERVENTION:

Landscape intervention is an involvement of additional spaces and activities into the existing function and surrounding area in an orchestrated way bringing equal balance in form, space, order and engaging users. It is created to meet the aspirations of people and improve their ideologies. It creates an optimal connection

## BRIEF UNDERSTANDING:

As the world is moving faster, people are getting busier and busier, forgetting their responsibilities and duties towards their self and more towards the elderly. The site is tucked between the old age home and Cancer hospital, with existing vegetation and trees alongside an artificial lake and a river by side. The landscape intervention will help giving them a safer environment and reliving their lives again, being active in the world giving them hopes and living their lives in a dignified manner.

## PROXIMITIES:



1

CREATION TO INNER PEACE  
OR KEEP IT SERENITY NESTLED IN GREENERY

MSL 2020-21

63-MSL-106





## SITE CONTEXT:



People buying their daily necessities and accessories from the nearby shops.



Elders interacting with each other and the nature near their homes.



Treatment of the cancer patients along with the research for the cure of cancer.



Workers and nurses taking the elderly and the patients for a wave of fresh air.



People gathering in mandir to pray for betterment and doing bhajans.



Worker's Quarters



Old age home near site

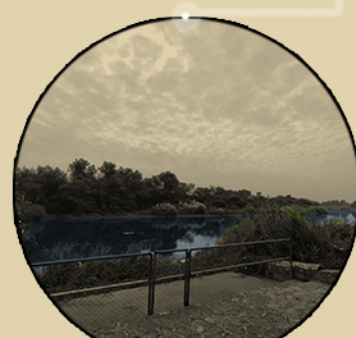

Dev river's view from site



Aerial Views of Site



Kailash, Kurad (A pond)

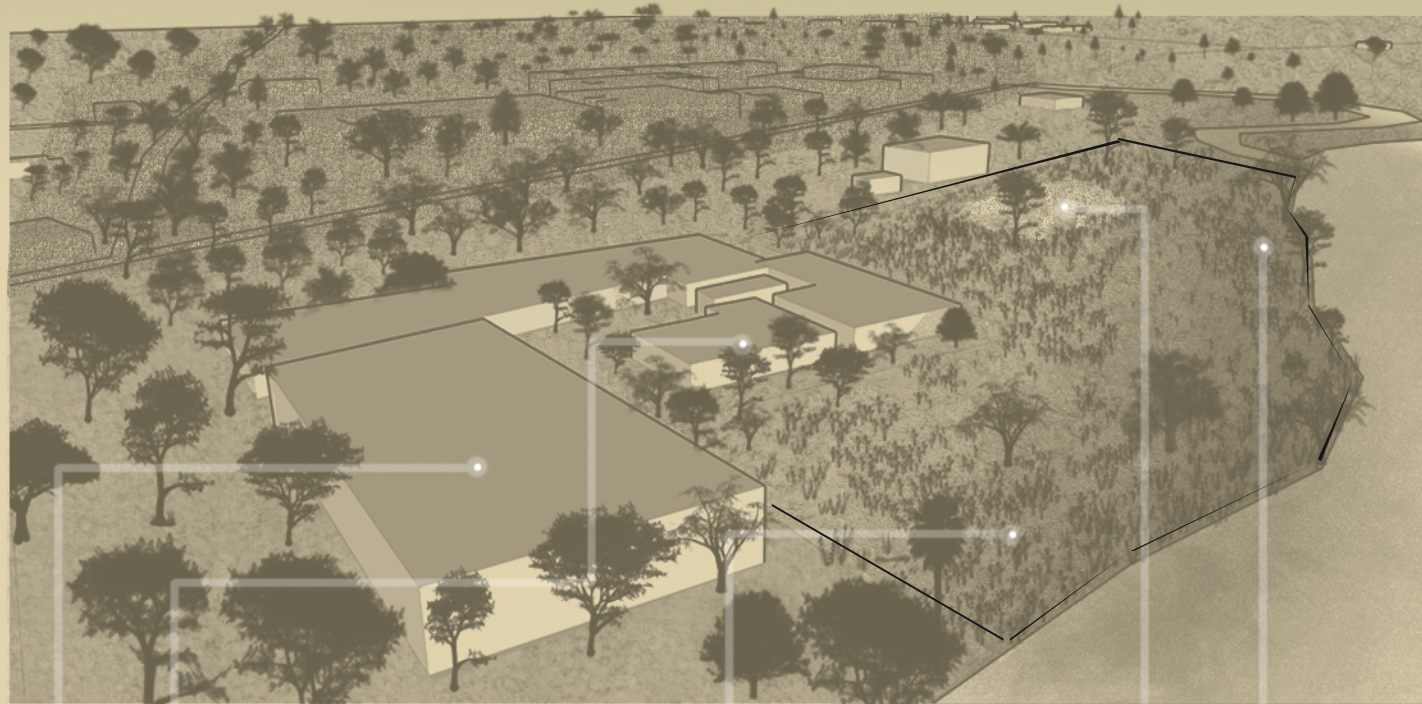

## SITE JUSTIFICATION:

- > The site located alongside the river and artificial pond in the site making their no shortage of water for the vegetation growing in the nearby area.
- > The land inherits alluvial sandy loamy soil favoring the growth of various types of trees and plants.
- > The site supports the elders living in the old age home nearby giving them a chance to be active and happy by engaging themselves in the activities and functions.
- > Old age is the time of significant change. The aim of designing the new landscape is to have greater motivation and inclination to enjoy the outdoors from gathering and sitting to experiencing walk in the park.
- > The site is held between a mentally retarded hospital, old age home and a cancer hospital, serves the sole purpose of giving hope, activeness and independence to the people.

## TESTIMONIES:



"I feel isolated being here all day and I think the landscape intervention will help me pass time and do exercise."  
~Hitesh Kumar Bhatt, Resident



"I miss my grandchildren who pay visit to me once in a while. This landscape will help me keep busy and involved during the daytime."  
~Shilpaben Bhavsar, Resident



"The elderly only talk with us and the one's living here, we can clearly see them missing their family. The landscape intervention will help them to be more active and open to the environment."  
~Bhavik Mistry, Worker at MSA

## SITE FACTORS:

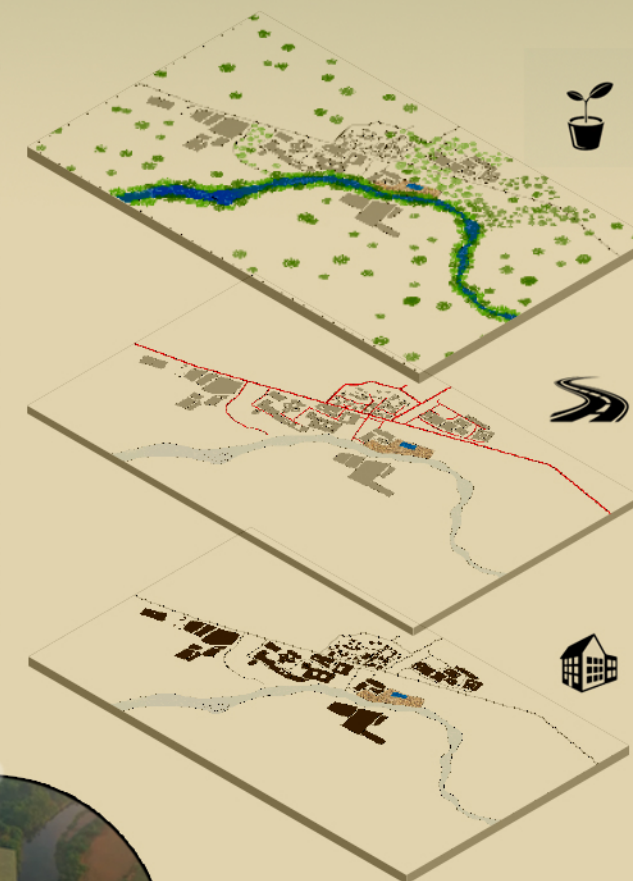

Memory Map of  
**goraj**



## FLORA & FAUNA

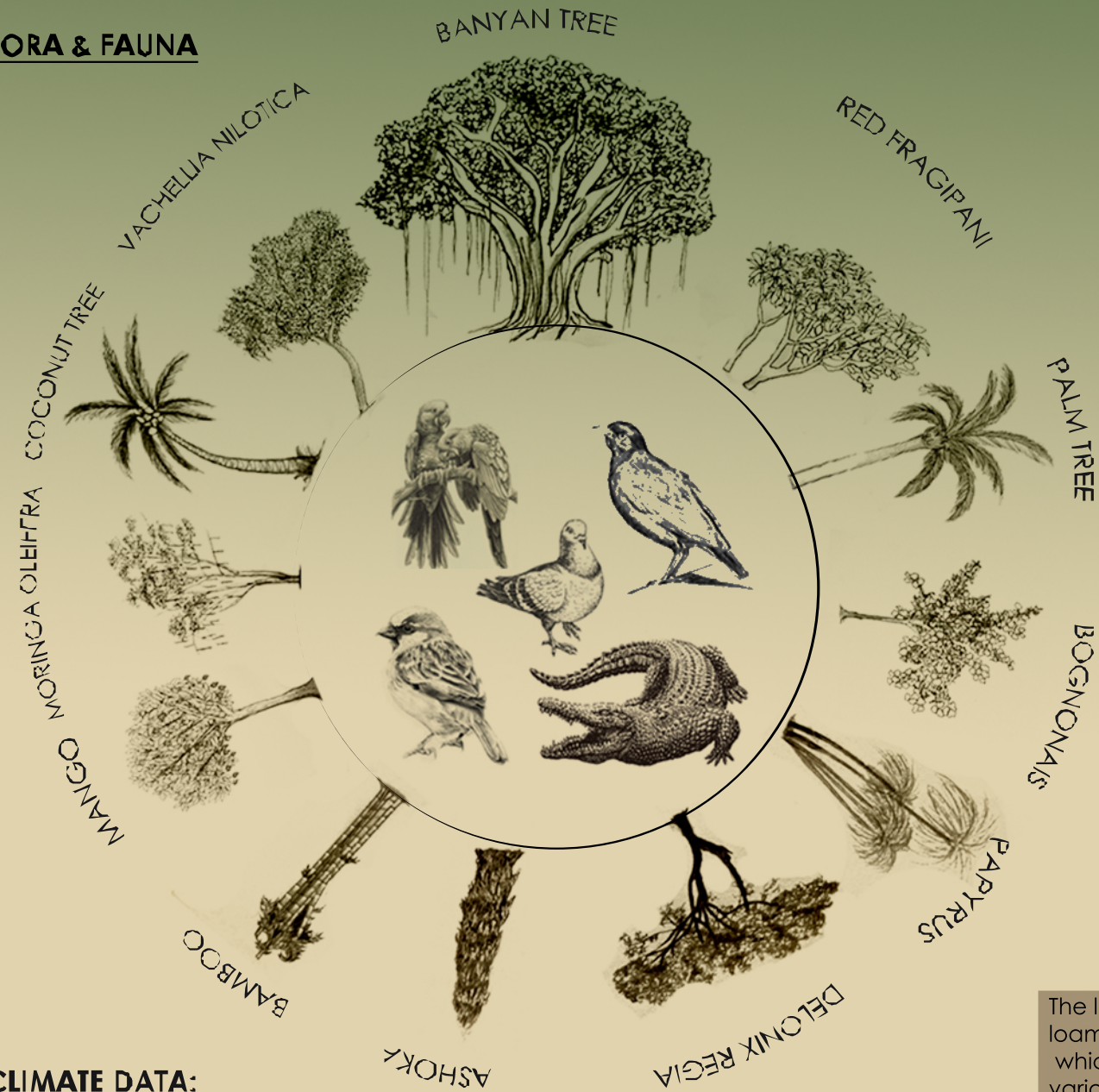

## CLIMATE DATA:

Goraj experiences mild rainfall during months of June to August, direct heat during summer.



The wind rate is very high in south-west while the speed is low in north west.

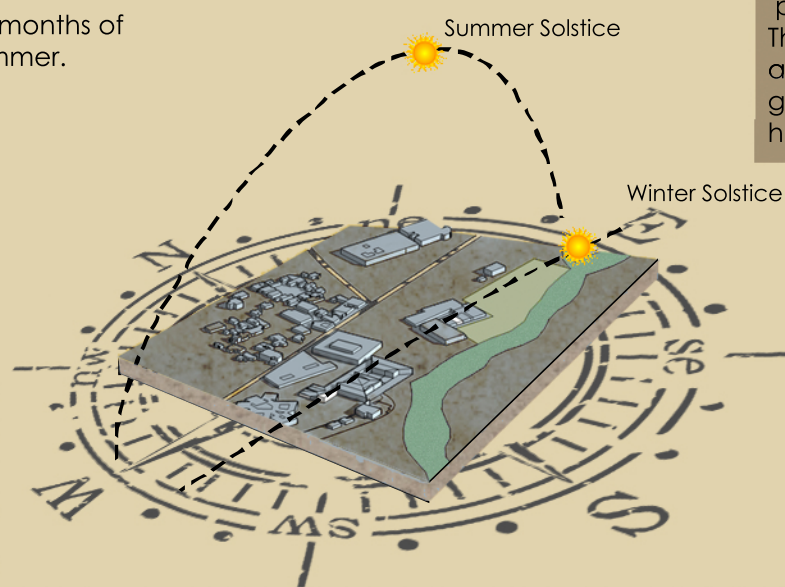
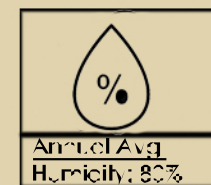
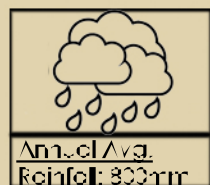

The land possesses alluvial loamy sandy soil, fertile soil which is favorable for various type of trees and plants. The site is for the pensioners and the cancer patient giving them glimmer of hope and sovereignty.

There's a dominant group of users visiting the place from the young to old.

The contour height varies at a wide range resulting into a very steep slope.

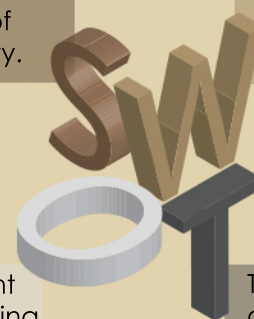

The river alongside the site generates difficulty of the existing species of wild animals like crocodile and snake that might approach near the site.

## SEASONAL SECTIONS:

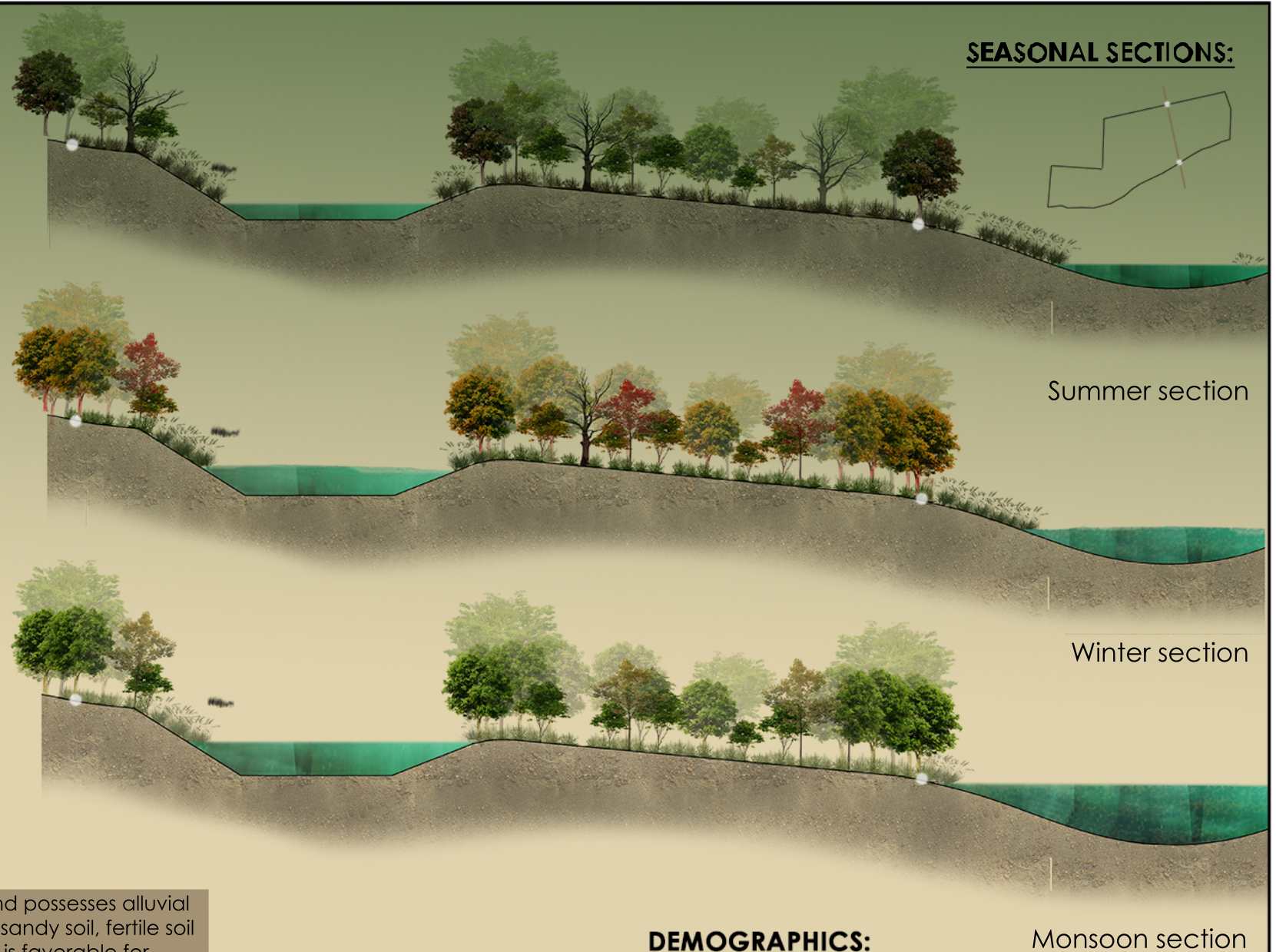

## DEMOGRAPHICS:

POPULATION



SEX RATIO



DENSITY



## Climatology & Biology of goraj



## MINDS FOR THE LAND



"How can a landscape intervention be perfect in all terms?  
What can we do to serve these golden agers?"

"Nowadays landscape intervention can be an absolute balance between science and nature."



"Wait a minute! There is always a perfect balance between art, science and nature as landscape intervention is an art in it self."

"I believe everything should be in an orchestrated way following form, space and order."



"Oh look at that banyan tree! It exactly depicts life of these lovely golden agers."

## PSYCHOLOGY:

A Banyan tree, especially one that lives for long years, is a true child of Mother Earth, and one that is possibly the closest to the heart of Mother Earth. It's life, when observed carefully, provides one deep insights into the world, and to life itself. Banyan tree is the 'mother of life'.

Banyan trees are characterized by aerial prop roots that mature into thick, woody trunks, which can become indistinguishable from the primary trunk with age. Here the banyan tree plays the role of the parent and the other are like kids. As the landscape intervention serves, old age people in the vridh ashram, this philosophy motivates that whatever the situation maybe, parents will always be same as banyan tree and will give the same amount of love and support to their kids.

## ART:

Landscape intervention is an ideal amalgamation of art, science and nature. The art in our landscape intervention is being typified as parametric, bonsai plant, roots, swings, play of light and many more.

## SCIENCE:

Time moving forward, the golden agers can expect some decline in their five senses. Strengthening the touch, smell, vision, hearing, taste involves science in reviving these senses. Creating a landscape intervention and bestowing such spaces will help them to recuperate their senses and be active.

## NATURE:

Roots display positive geotropism when they grow down ward .Directioning of roots is negative geo tropism as they grow upwards according to shape of formwork given.

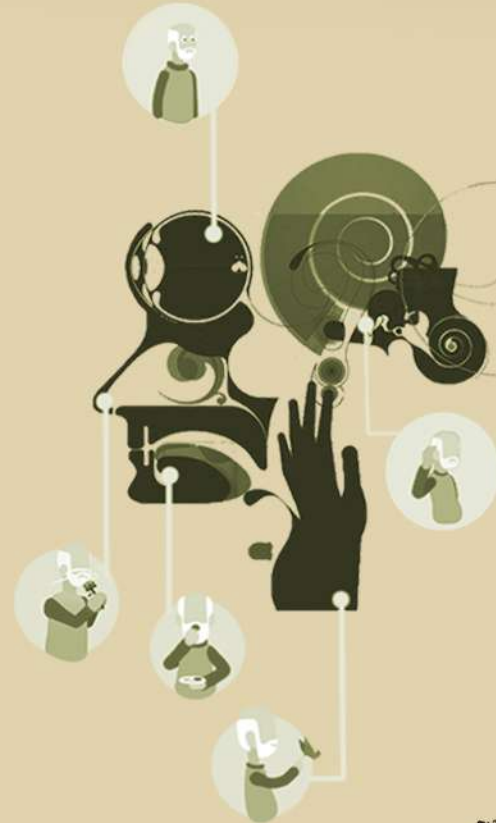

## AN EXCEPTIONAL BALANCE:

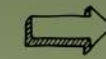

## FORM EVOLUTION:

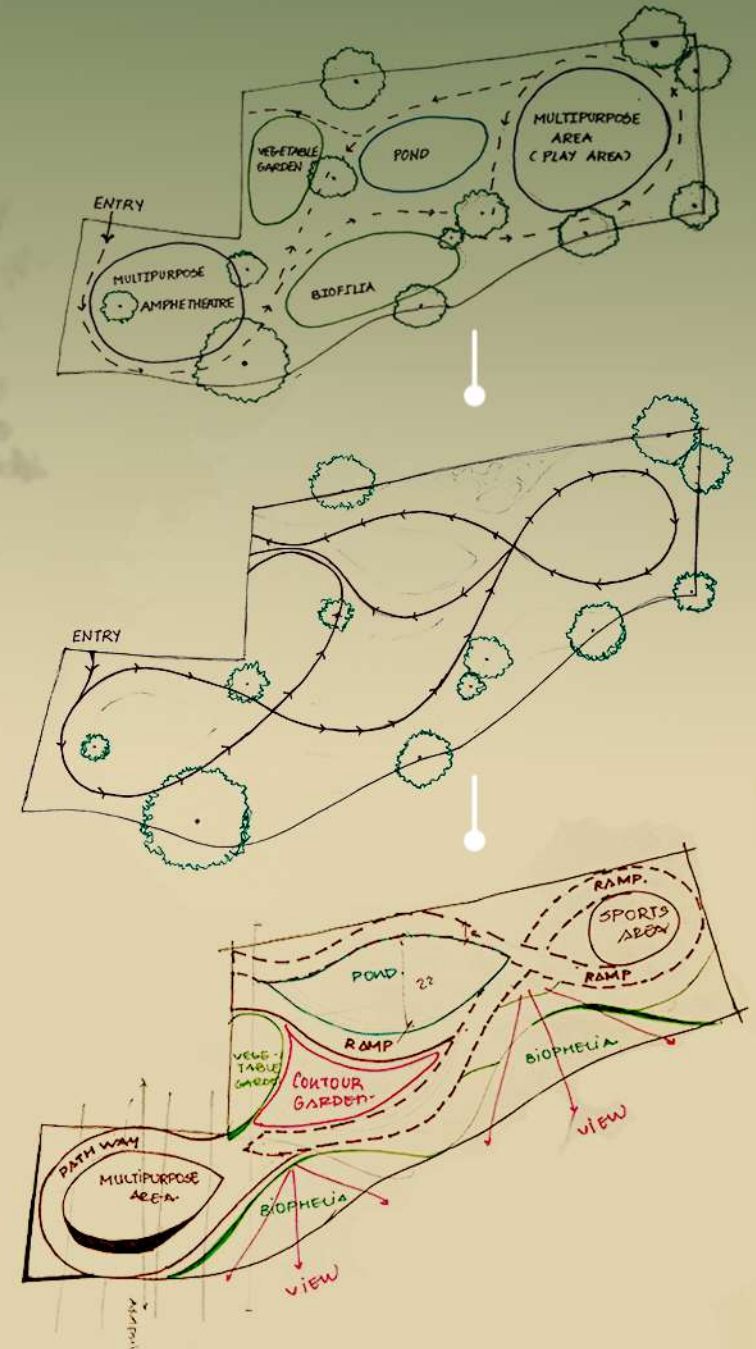

A living root bridge is formed by guiding the pliable roots of the Ficus elastica tree across a stream or river, and then allowing the roots to grow and strengthen over time until they can hold the weight of a human being.



nyagrodha  
vatika





A

Multipurpose expanse having venture activities which encourages golden agers i.e charity function fairs gathering seminars etc.



B

A covered sedentary, performs a welcoming extent for visitant and gives a comfortable clustered sitting.



C

Generating a aspiration and stimulation to live life and own endurance



D

Contemplating it as a quotidian venture which fabricate deep affection for passerine



E

The roof under the bridge gives a resting space to the one's passing byand giving them a scenery to sit and watch.

A. MULTIPURPOSE AREA

B. GAZEBO

C. CYCLING TRACK

D. PLATFORM

E. SHADING SPACE UNDER BRIDGE



MASTER PLAN

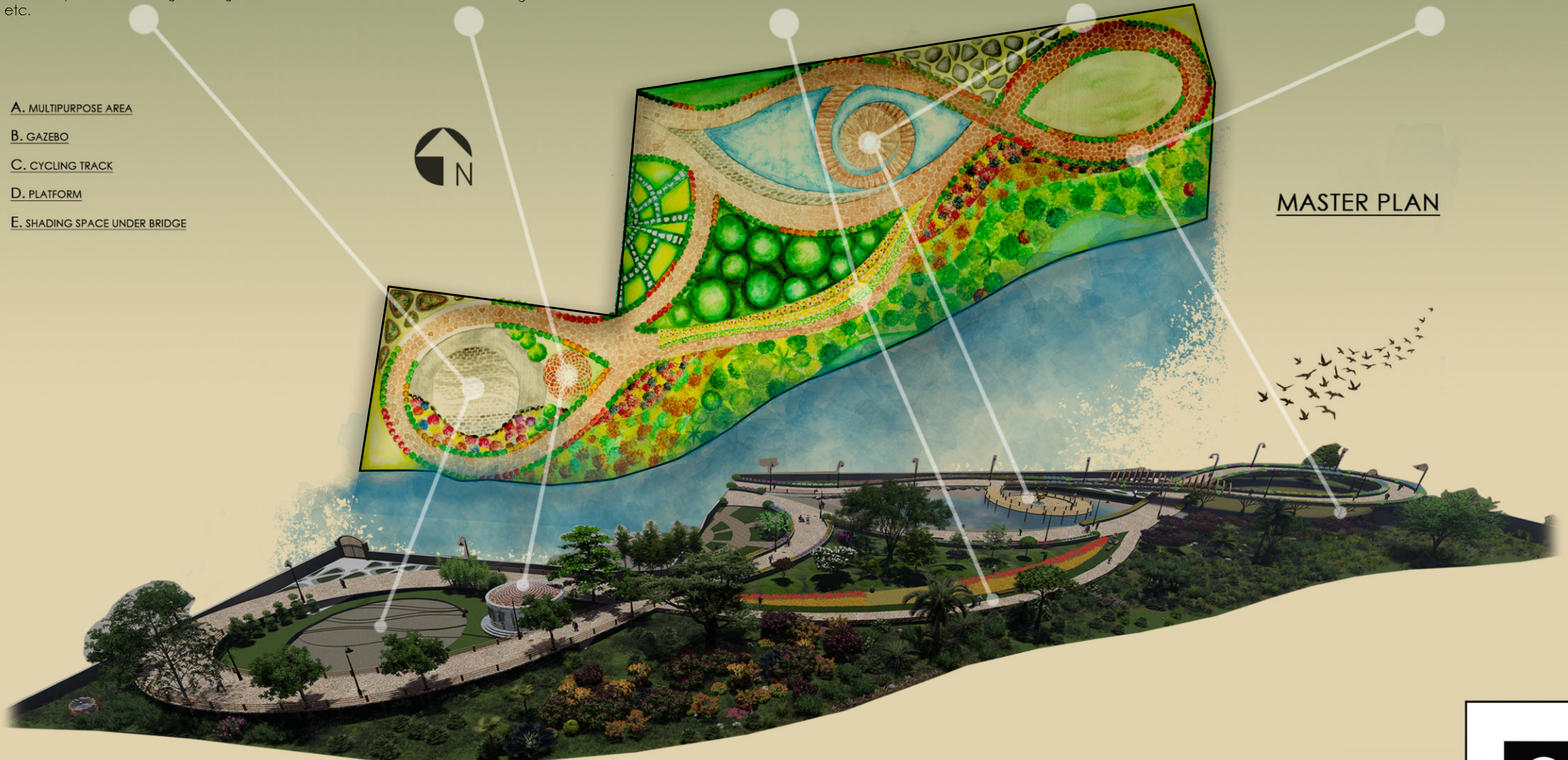







THE EXISTING LAND WILL BE MARKED FIRST FOR THE DIGGING UP PITS OR CHANNELS.



THE CHANNELS/PITS ARE DUG UP TO 20-30 CM

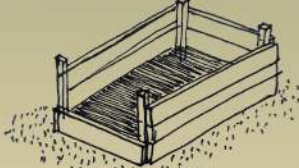

THE WOODEN PANELS ENCIRCLES THE EXISTING LAND GIVING THEM A CERTAIN HEIGHT.



THE WIRE MESH ON EQUAL DISTANCE IS PLACED IN THE PITS/CHANNELS AND A LAYER OF MUD IS COATED OVER.



MULTIPLE LAYERS ARE CREATED OF DIFFERENT SOILS SUPPORTING ALL KIND OF VEGETATION.

#### INTERACTION BETWEEN WATERBODY AND BIRDS/ANIMALS

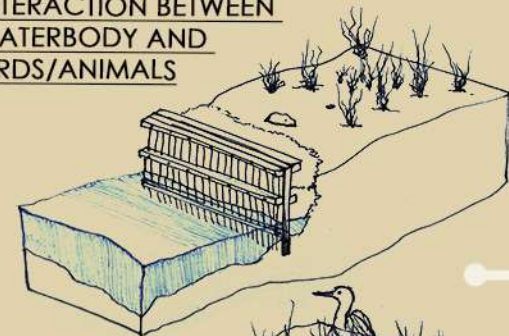

RETAINING WALL CREATES A BARRIER BETWEEN THE LIVING WILDLIFE SPECIES AND WATER. THE HARD INFRASTRUCTURE ABRUPTLY BREAKS OFF THE ECOLOGICAL CONNECTION BETWEEN THE COAST AND WATER.

#### VEGETABLE GARDEN DESIGN



TECHNIQUE USED IN DEVELOPING VEGETABLE GARDEN



RAMP DETAIL

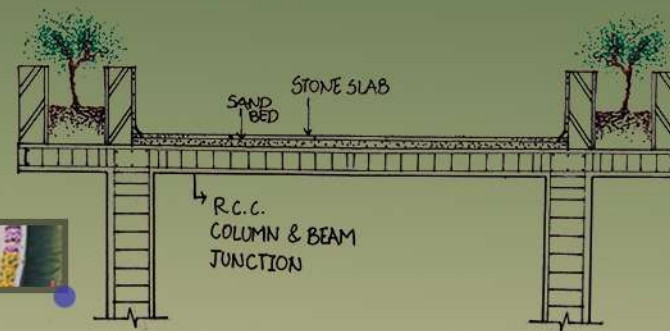

BIRD FEED PLATFORM

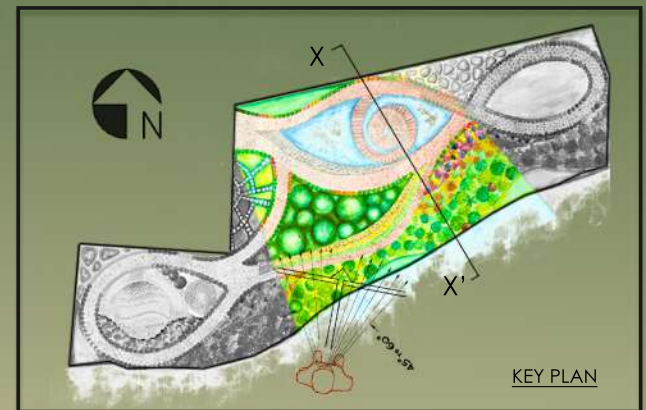

#### BIOPHILIA GARDEN PLANTS

BIOPHILIA  
in between  
NATURE + HUMAN  
element of nature



CHAMPA



JASMINES



ROSES



SWEET ALYASSUM



GARDENIA



#### BIOPHILIA AND CONTORE GARDEN IN LANDSCAPE DESIGN



SECTION X-X'



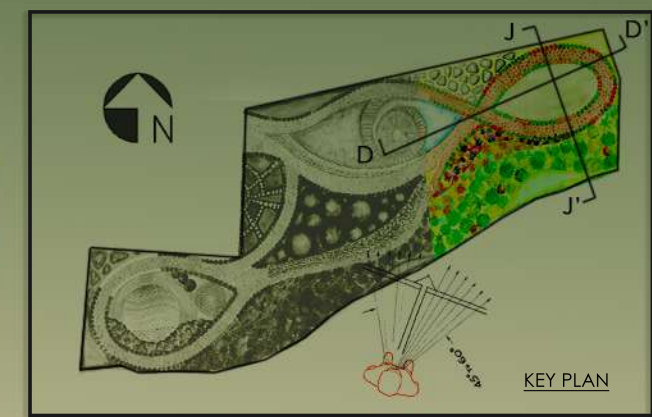
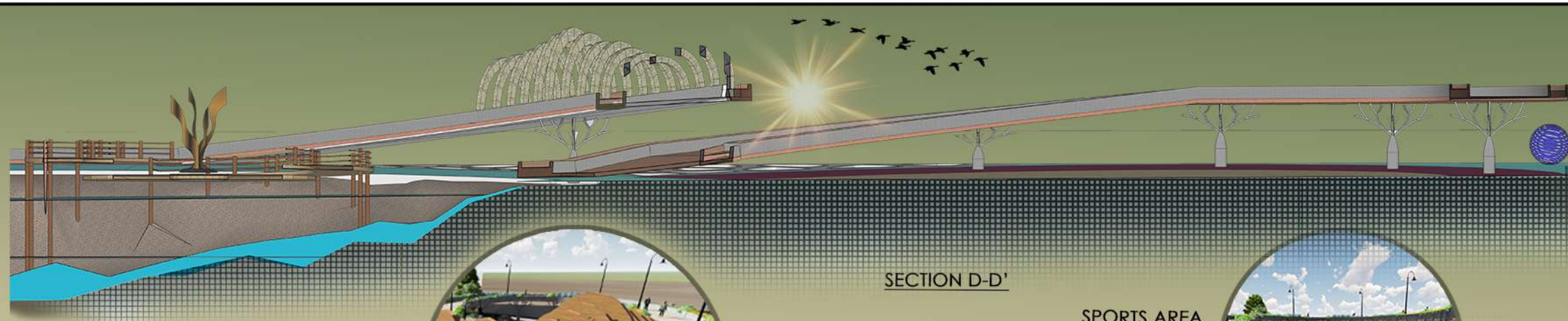

ARCHES ON RAMP



SPORTS AREA



COLUMN DESIGN  
BEHIND THE RAMP



NIGHT VIEW

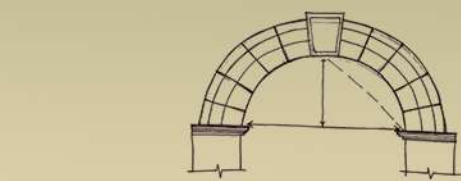

THA SMOOTH CURVE, CANOPY ON THE BRIDGE CREATES ENJOYABLE WALKING ESSENCE AND THE LEDS WERE AFFIXED TO CABLES TO CONVEY A NET-LIKE FEELING OR THE RIGGING OF A SHIP



DAY VIEW



STREET VIEW

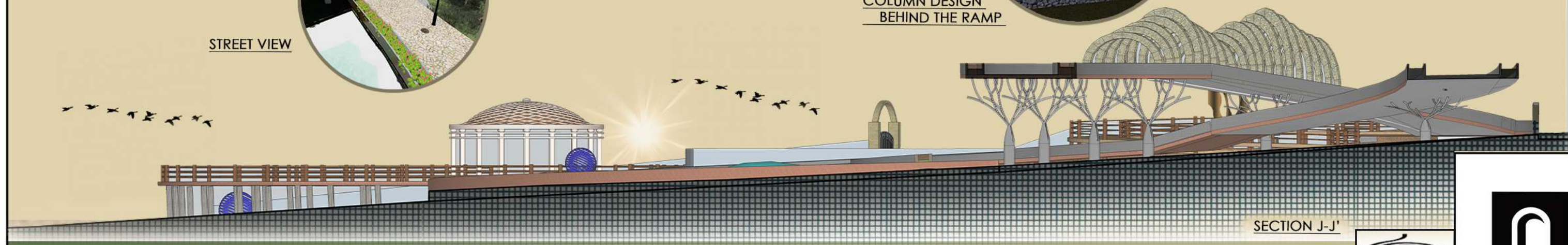

SECTION J-J'